



ROUPEIRO COPACABANA NEW 04 PTS
Código: 8081

Benetil
Móveis

Av. Jesus Candian, 395 - B. Mangueira Rural
Telefax (32) 3539-5350
CEP 36500-000 - Ubá - Minas Gerais
www.benetil.com.br

RELAÇÃO DE FERRAGENS EM TAMANHO REAL (MEDIDA EM MILÍMETRO).



A - PARAF. 3,5x14

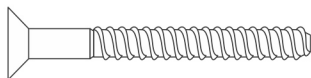

B - PARAF. 5x40

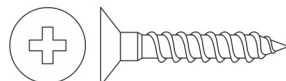

C - PARAF. 4,0x25

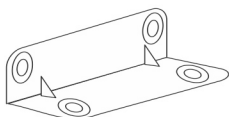

D - CANTONEIRA 4 FUROS

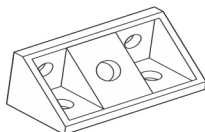

E - CANTONEIRA 4 FUROS

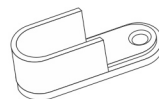

F - SUPORTE CABIDEIRO



G - CAVILHA 6x30

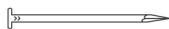

H - PREGO 10x10

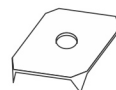

J - FIXADOR DE COSTAS



M - PUXADOR

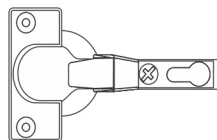

N - DOBRADIÇA

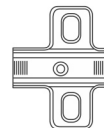

O - CALÇO

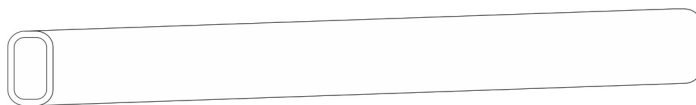

P - CABIDEIRO

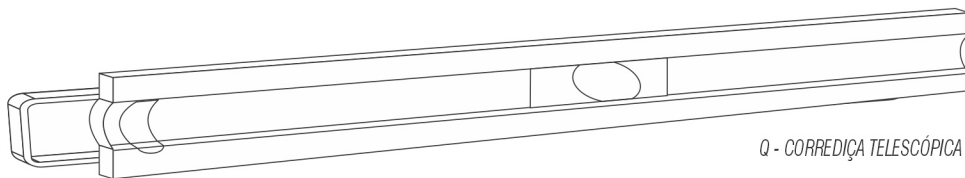

Q - CORREÇÃO TELESCÓPICA

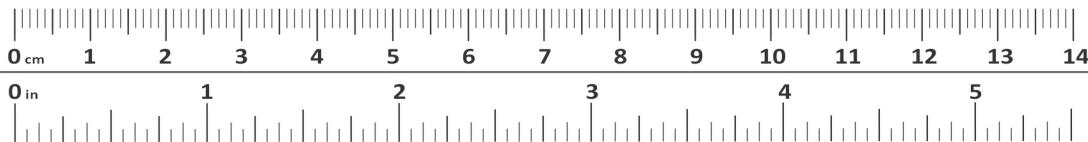

3

UTILIZE A RÉGUA PARA A MEDIÇÃO DOS PARAFUSOS

FAVOR IDENTIFICAR AS PEÇAS E COLOCAR SEUS RESPECTIVOS ACESSÓRIOS

Sequência de Montagem

- 01 - Parafusar peça 2 nas peça 3;
- 02 - Parafusar peça 1 nas 2;
- 03 - Parafusar peça 4 nas peças 2;
- 04 - Parafusar os Pés 21 nos rodapés 2.

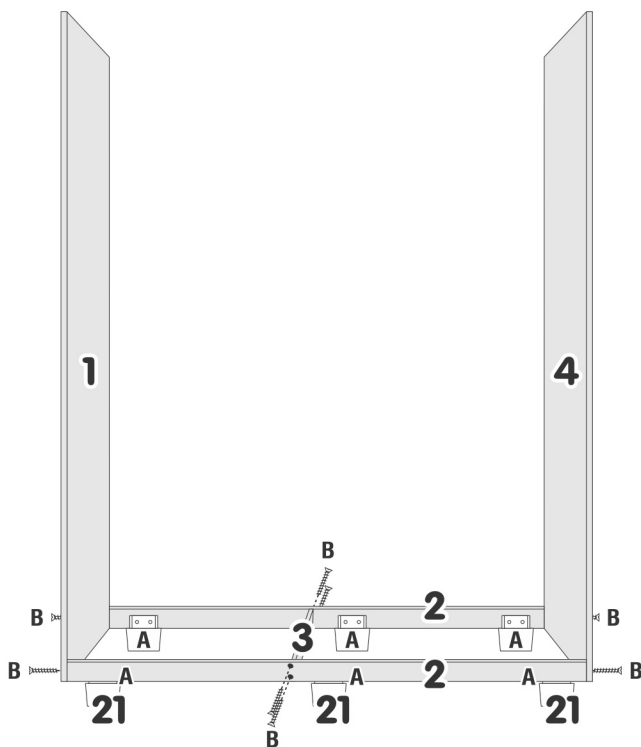
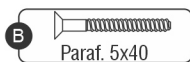
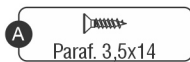

Sequência de Montagem

- 05- Parafusar peça 5 nas peças 2;
- 06- Parafusar as peça 6 na peça 5 conforme desenho

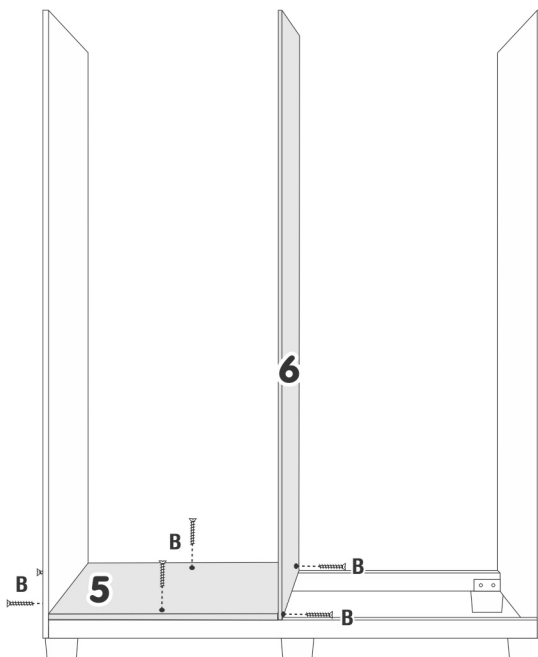

Sequência de Montagem

07 - Parafusar as peças 10 nas peças 1, 4 e 6.

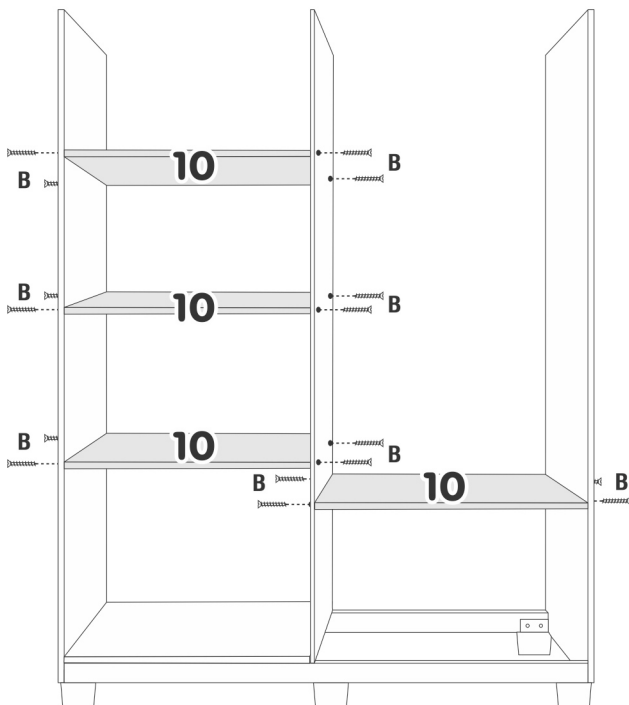
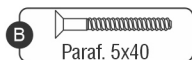

Sequência de Montagem

08 - Parafusar as peças 12 nas peças 1, 4 e 6.

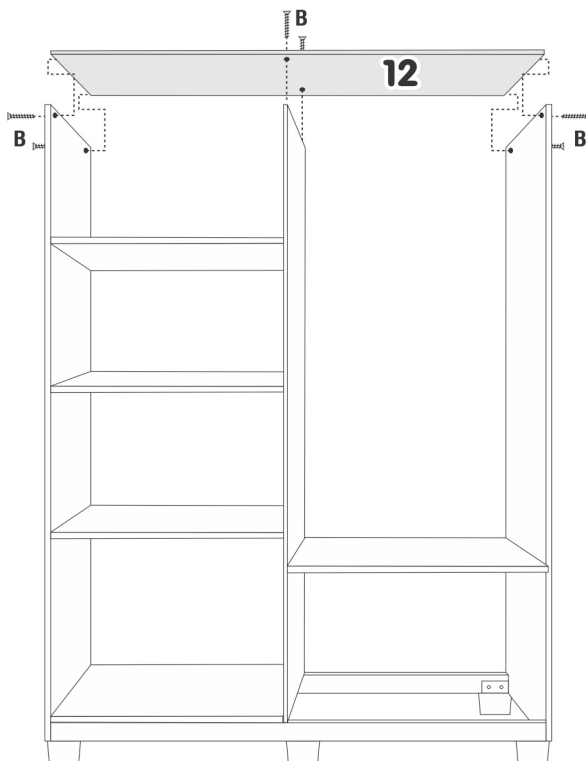
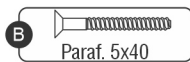

Sequência de Montagem

09 - Parafusar a peça 13 nas peças 1, 4, e 12.

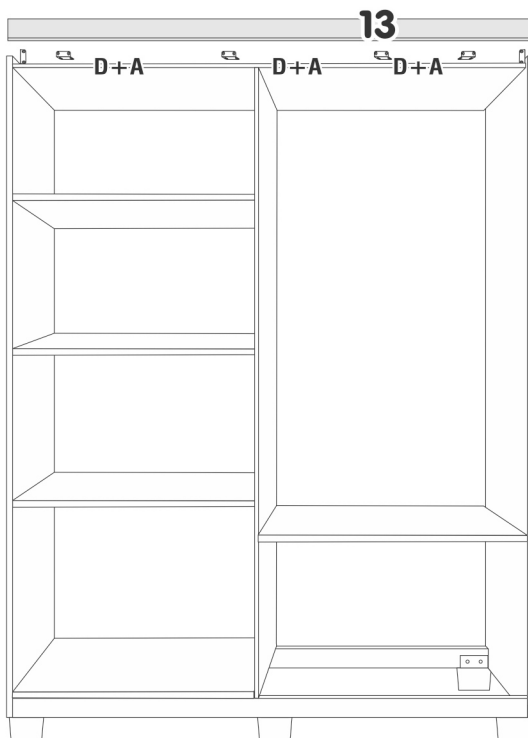

Sequência de Montagem

10 - Parafusar as corrediças nas peças 4 e 6;
11 - Parafusar suporte de cabideiro conforme desenho ao lado.

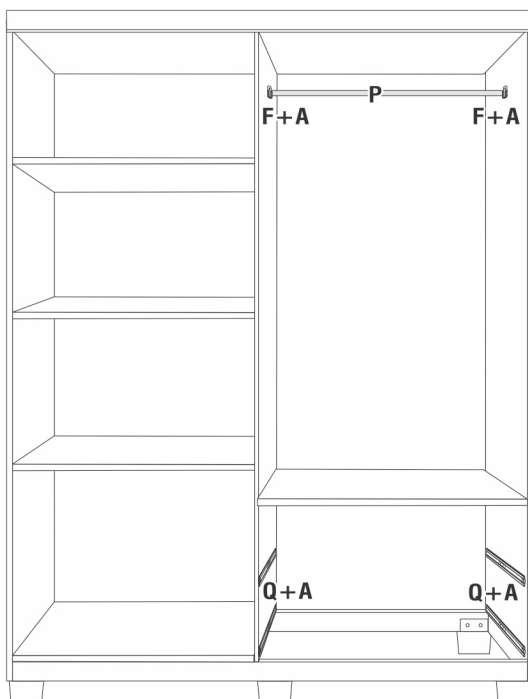

Sequência de Montagem

12 - Montar e fixar as Portas 14 e 15.

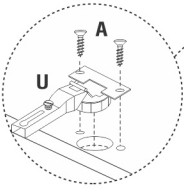

- A** Paraf. 3,5x14
- C** Paraf. 4x25
- M** Puxador
- N** Dobradilha Pressão
- O** Calço

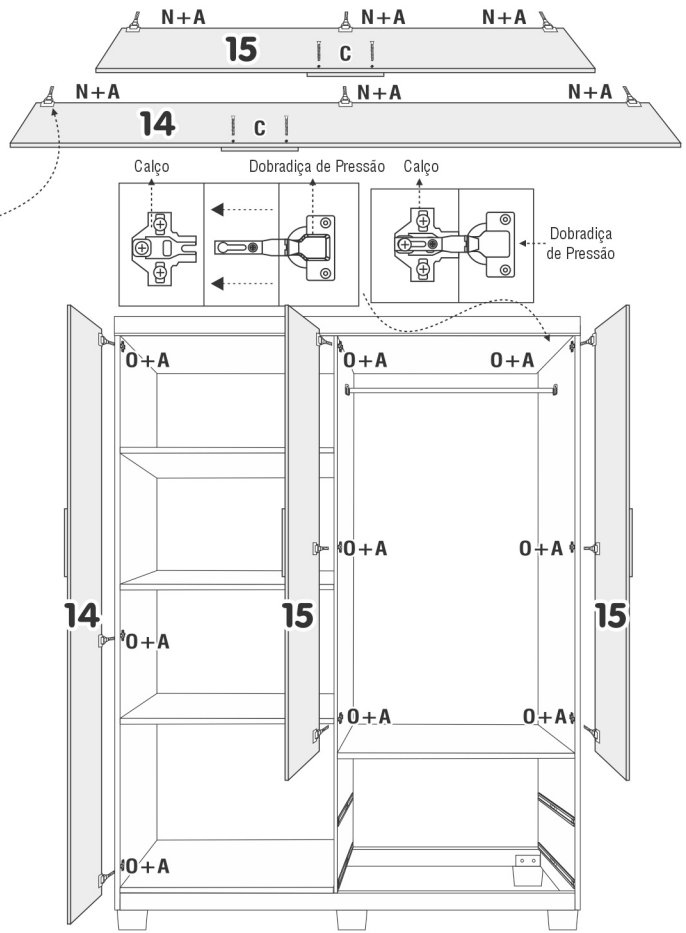

Sequência de Montagem

13 - Pregar as Costas 20 conforme desenho ao lado.

OBS.: Acertar as costas para melhor esquadramento do móvel.

- H** Pregos 10x10
- J** Fixador de Costas

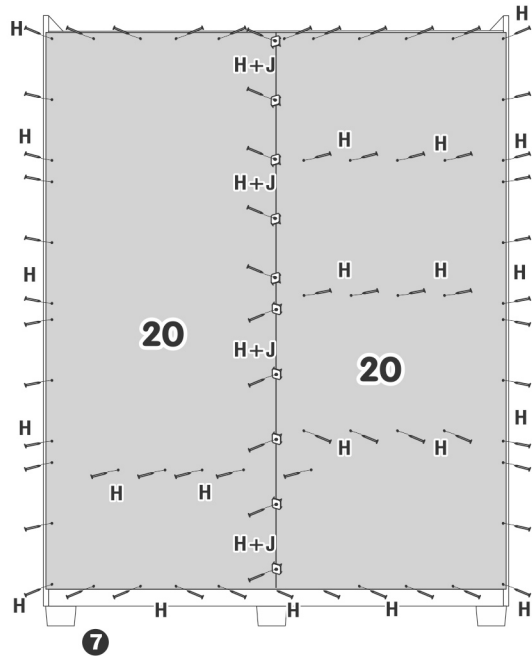

Sequência de Montagem

- 14 - Parafusar as cantoneiras nas peças 17;
- 15 - Parafusar as peças 17 nas peças 16;
- 16 - Parafusar a peça 18 nas peças 17;
- 17 - Parafusar peça 19 nas peças 17 e 18 conforme desenho abaixo, ajustando para melhor esquadramento da Gaveta;
- 18 - Parafusar as correições nas laterais da peça 17.

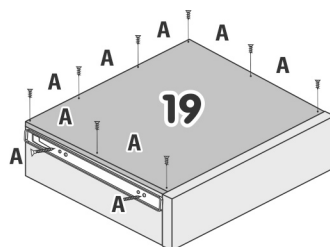
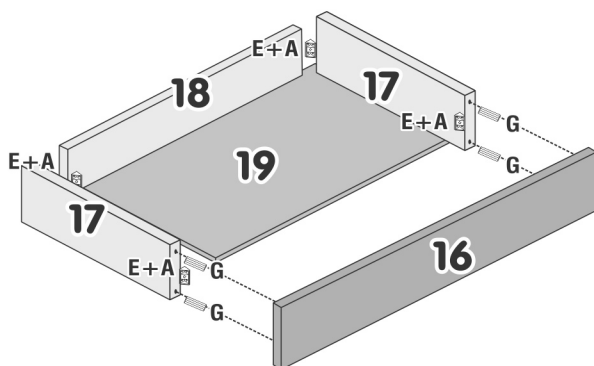

Benetil

Móveis

Av. Jesus Candian, 395 - B. Mangueira Rural
Telefax (32) 3539-5350
CEP 36500-000 - Ubá - Minas Gerais
www.benetil.com.br